



11 Peterscourt, King's Lynn PE30 4XZ

£229,995

3 1 2



Close to the Hospital!! Set within a close, in one of the most sought after parts of King's Lynn this bright and airy, end of terrace house could be the ideal first home or perfect next house to expand your property portfolio. It boasts allocated parking, private garden and 23ft garage too.



Key Features

- End of Terrace House
- Close to Queen Elizabeth Hospital
- 23ft Garage
- Sought After Location
- Gas Central Heating
- Three Bedrooms
- Kitchen/Dining Room
- Allocated Parking
- Private Garden
- Set Within Cul-de-sac

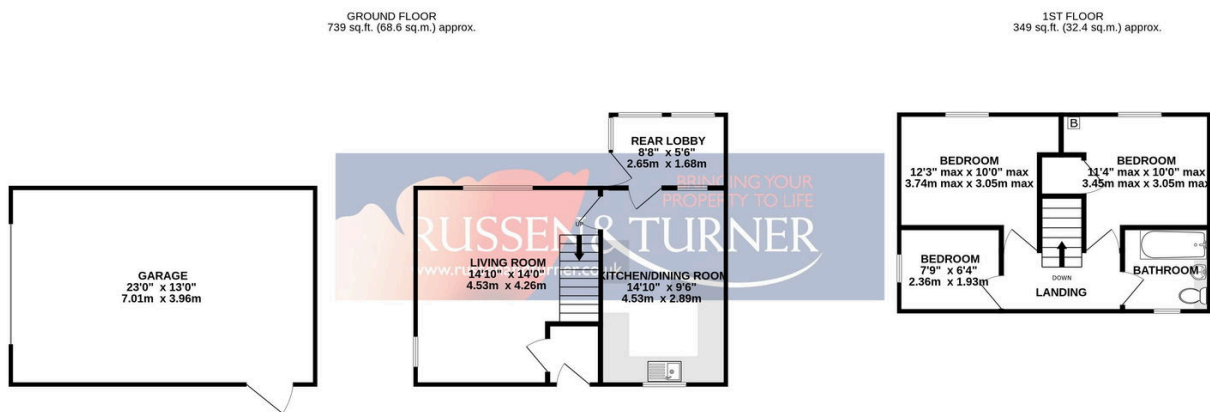

GROUND FLOOR
739 sq.ft. (68.6 sq.m.) approx.

1ST FLOOR
349 sq.ft. (32.4 sq.m.) approx.

TOTAL FLOOR AREA: 1088 sq.ft. (101.0 sq.m.) approx.

Whilst every attempt has been made to ensure the accuracy of the floorplan contained here, measurements of doors, windows, rooms and any other items are approximate and no responsibility is taken for any error, omission or mis-statement. This plan is for illustrative purposes only and should be used as such by any prospective purchaser. The services, systems and appliances shown have not been tested and no guarantee as to their operability or efficiency can be given.
Made with Metropix ©2024

